



Genesis
For the Perfect Finish

BLFMCR - Manual Cutting System



Operating Instructions
Please read before using

- Suitable for tile size up to 3.6m

- Adjustable length of 1.4m and 2.2m
- Professional carbide cutter - $\varnothing 22 \times \varnothing 6 \times \varnothing 6$



Genesis
For the Perfect Finish



01/ Install the Rail



02/ Fix the Rail

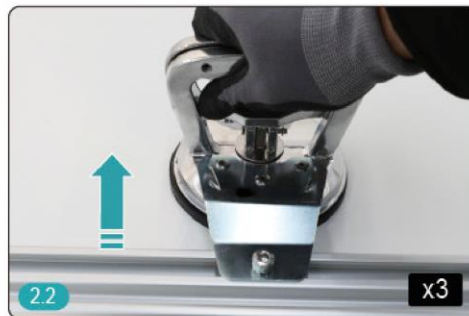
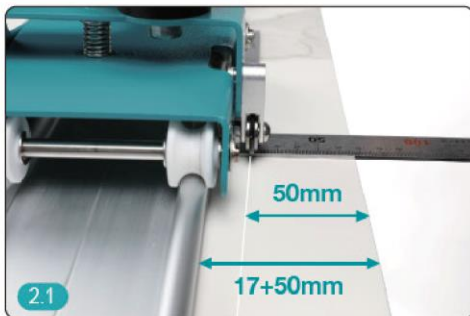

03/ Operation

