



Working Bench

- ✓ Table size 1.8x1.4M
- ✓ Maximum load 200Kg (441 lbs)
- ✓ Suitable for tile size upto 3.6x1.4M after 2 tables joint together



COMPONENTS



01/ Install the Base

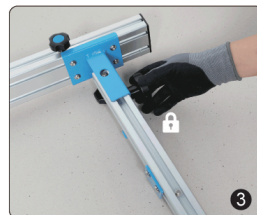
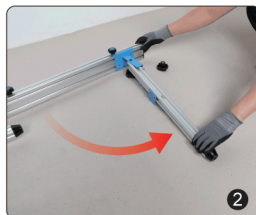

02/ Install the Support Bar

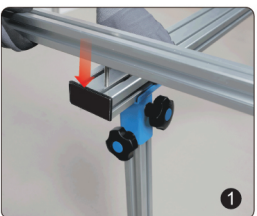

03/ 1 set Finished Product

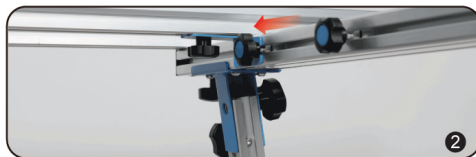

04/ 2 sets Joint Together

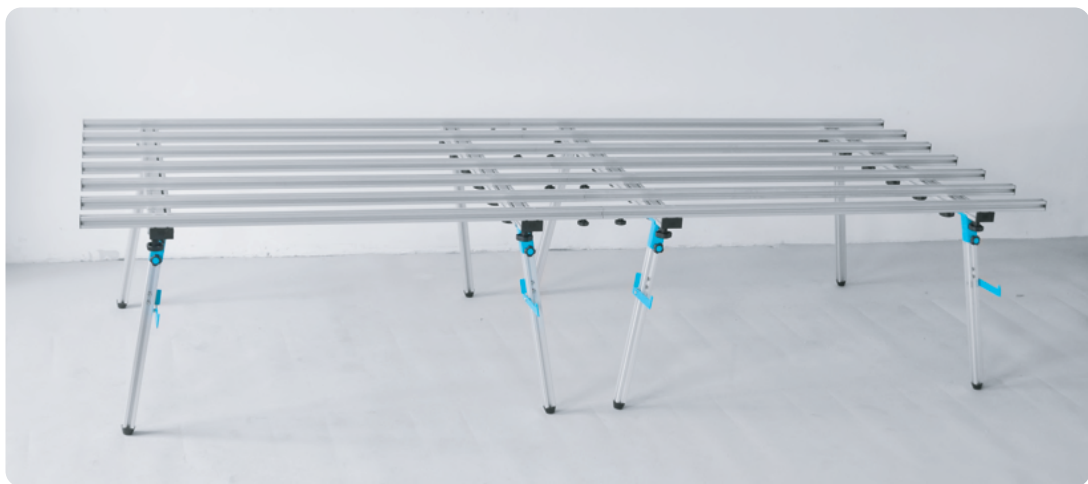
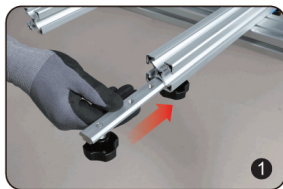



Genesis

For the Perfect Finish

 **BIHUI**[®]
PROFESSIONAL TILING TOOLS

